

N=Number of contacts

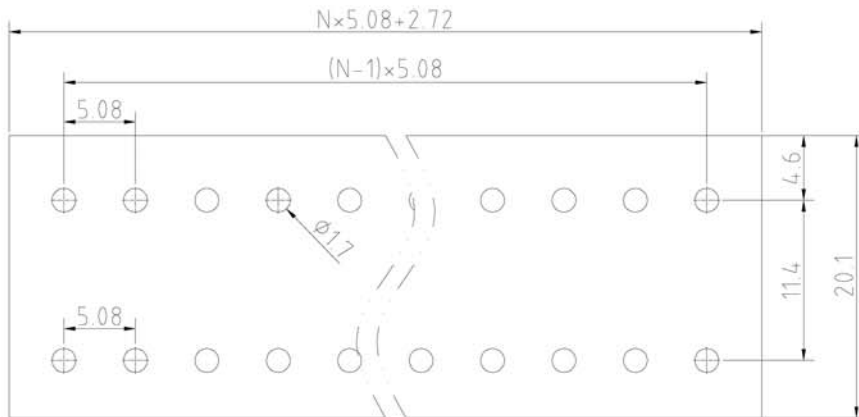

P.C.B. LAYOUT

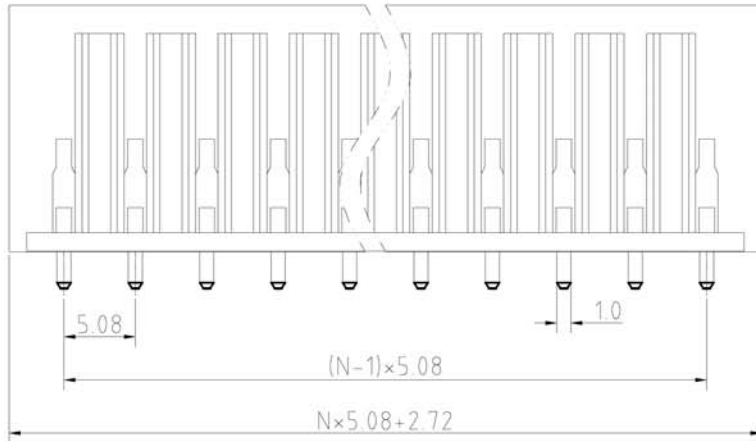
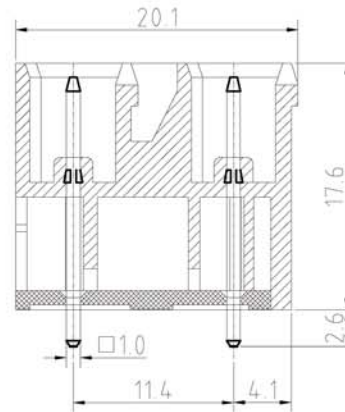

SIGN	DESCRIPTION	DATE	APPROVER

Technical Data:

Material:

Solder Pin: Copper Alloy with Tin plated
 Insulator body(housing): Polyamide
 (Glass filled)(UL94V-0)

Electrical

Voltage rating: 300VAC
 Current rating: 16A
 Withstanding Voltage: AC 2500V(1min)

Mechanical:

Using temperature Range: -40°C to +105°C
 Soldering temperature: +250°C, 5seconds Max.

Ordering Information:

F85-R-E XX-0 0 0 X 0 0 0 0

02	2Pin	5	Green
To	To	6	Blue
24	24Pin	A	Black
0	180°	0	Open
1	90°	1	Close
		2	Screw nut
		3	Square nut
		4	W/Latch holder

WELINK

上海拓尔普电子科技有限公司

Welink International Co.,LTD.

TOLERANCE	APPROVED:	NAME:	F85-R Pitch 5.08mm
X. ±0.50	CHECKED:		-Series-180° (Close)
X.X ±0.30	DRAWN: Ling Yu	2014,09,18	
X.XX ±0.20	UNITS: mm	REV: A	PART NO: F85REXX001X0000
X° ±*	SCALE: 2.5 / 1	PAGE: 1 / 1	DWG NO: 9F85RE011A